

### GS6 Hydraulic Lift 11.8 Inch Travel Installation Instructions

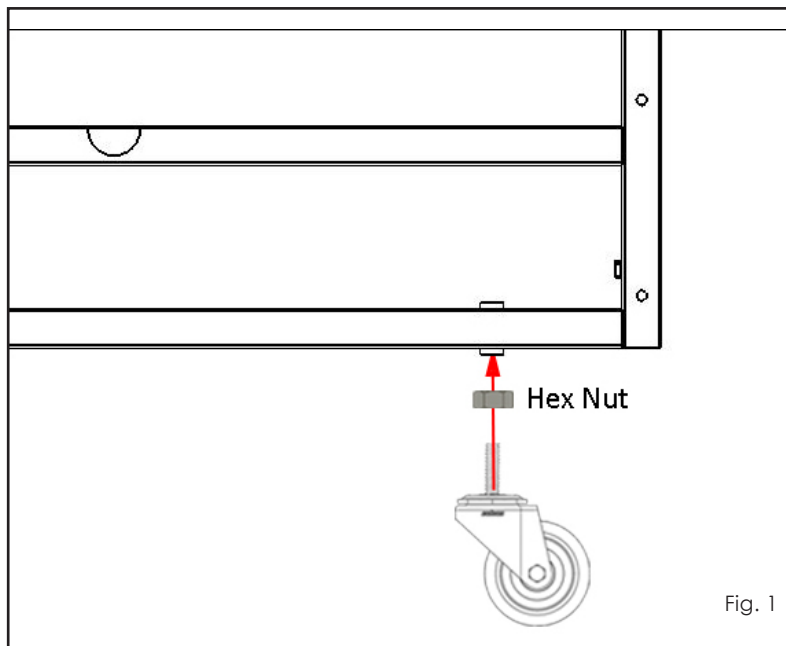

See the provided parts index on page 4 for needed materials

#### Instructions

1. Install legs on table as instructed in Gammill dealer training.
2. Thread 5/8" jam nut onto each castor then install castors on legs by threading them into inserts on lower crosspiece. Install locking castor on front side. Do this for both legs. (Fig. 1)
3. Using #8 x 3/4" self-drilling screws, install hydraulic pump bracket "A", hydraulic pump bracket "B" and the hydraulic switch bracket to table as shown below. (Fig. 2).

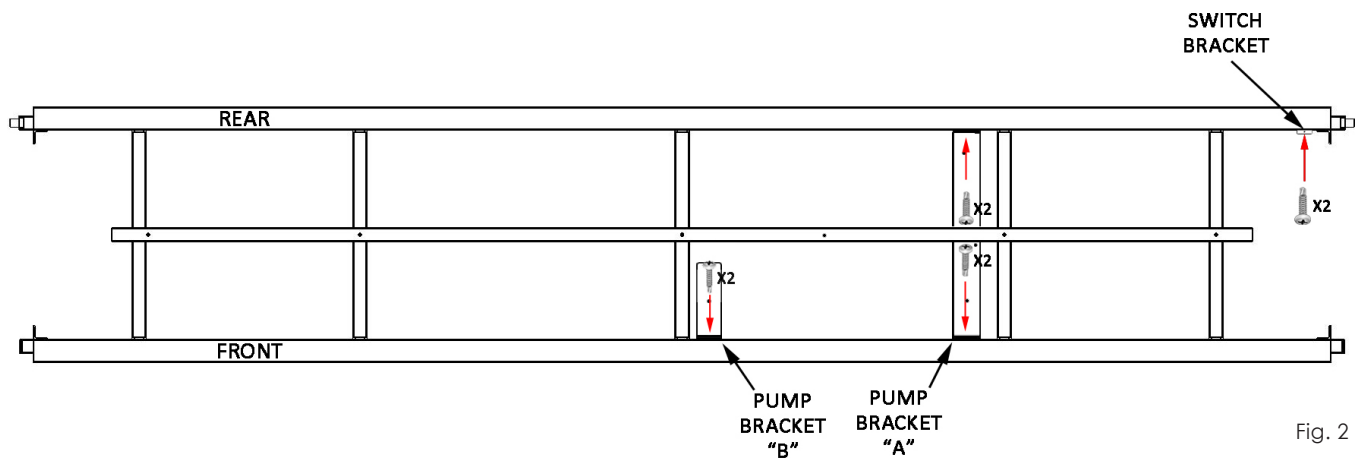

# Gammill<sup>®</sup>

## INSTRUCTIONS

### Hardware Placement

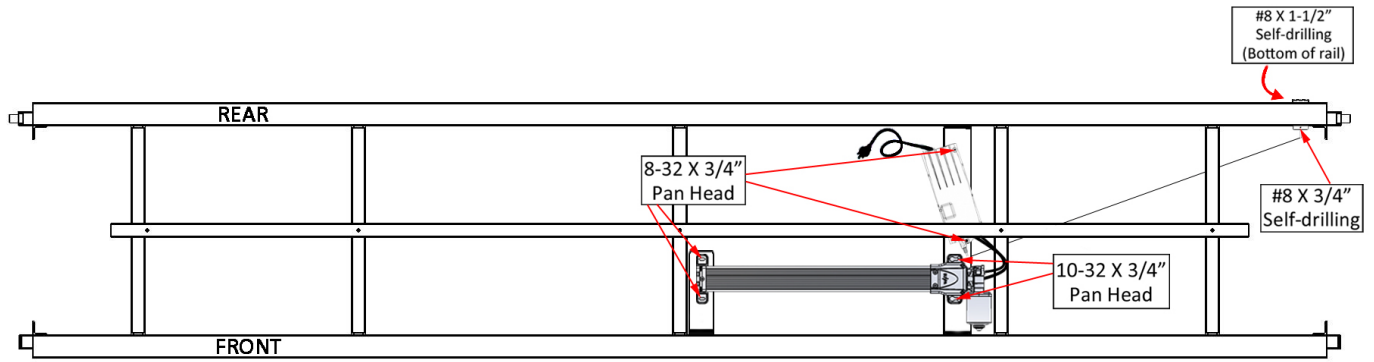

Fig. 3

4. Install hydraulic pump, control module and switch onto mounting brackets. Connect AC power cord and switch wire to control module. (Fig. 3)
5. Remove ties from hydraulic hoses one at a time and carefully place one hydraulic cylinder near each of the four corners of the table. (Fig. 4)
6. Plug both cables from the hydraulic pump into their designated locations on the control module. The plugs and control module locations are labeled "M1" and "M2". (Fig. 5)

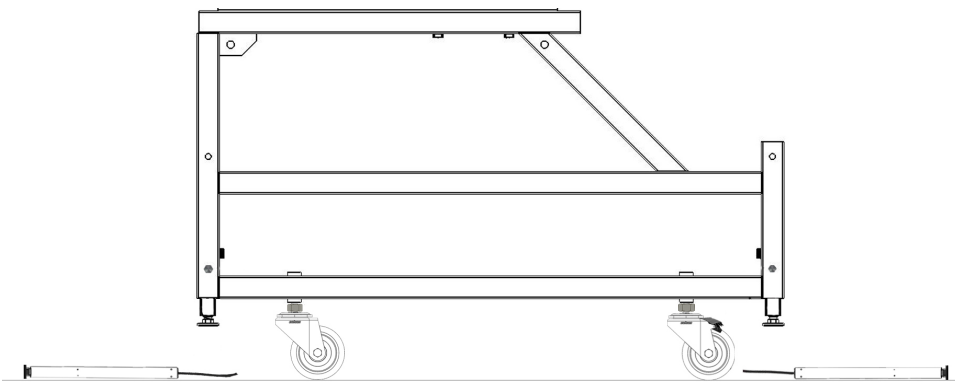

Fig. 4

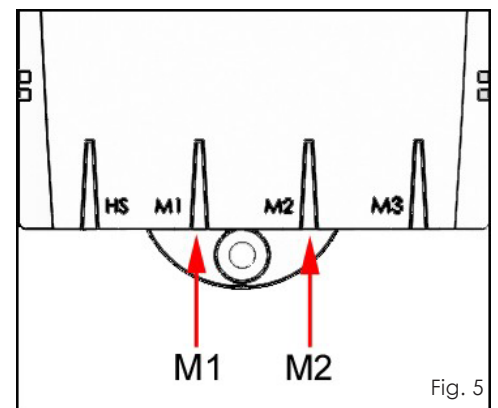

Fig. 5

### **\*IMPORTANT\***

**Be extremely careful when handling hydraulic hoses. Damaging one could result in hydraulic system failure.**

# Gammill<sup>®</sup>

## INSTRUCTIONS

7. Insert hydraulic cylinders into mounting brackets and align screw holes on flat side of cylinder with corresponding holes in each bracket. The adjustable leveling foot on the cylinder passes through the open end of the mounting bracket (bottom) and the hydraulic hose exits the opposite end of the bracket (top). Secure hydraulic cylinder to mounting bracket using 10-32 X 3/8" button head screws (4 per bracket) and an 1/8" Allen wrench. (Fig. 6)

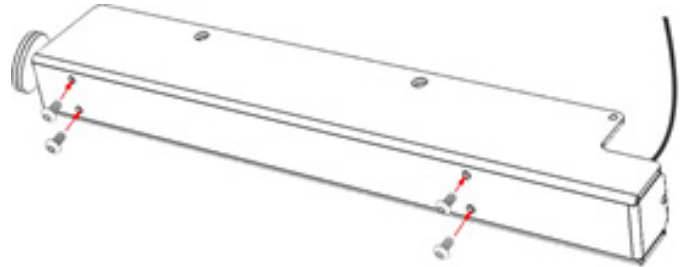

Fig. 6

8. Loosen black insert locking bolts and remove 9/16" hex nuts, washers, and height adjustment bolts using a 9/16" socket wrench and box wrench then slide leg insert up into leg until bolt holes align in the highest position. (Fig. 7)
9. Hold insert in place while installing cylinder mounting bracket and hydraulic cylinder to leg by aligning bolt holes on bracket with the corresponding holes in the leg. Using a 9/16" socket wrench and box wrench, secure brackets to legs with 3/8" hex bolts (2 per bracket), 3/8" flat washers, 3/8" lock washers and 3/8" hex nuts. (Fig. 8)

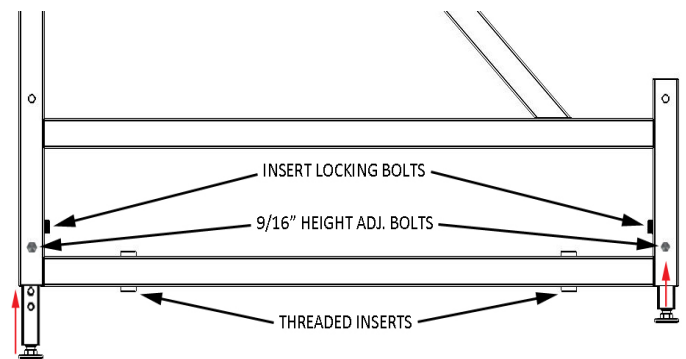

Fig. 7

10. Neatly roll up any excess hydraulic lines and secure them to bottom side of table frame using zip ties. Route lines so they won't interfere with anything while table is in use.

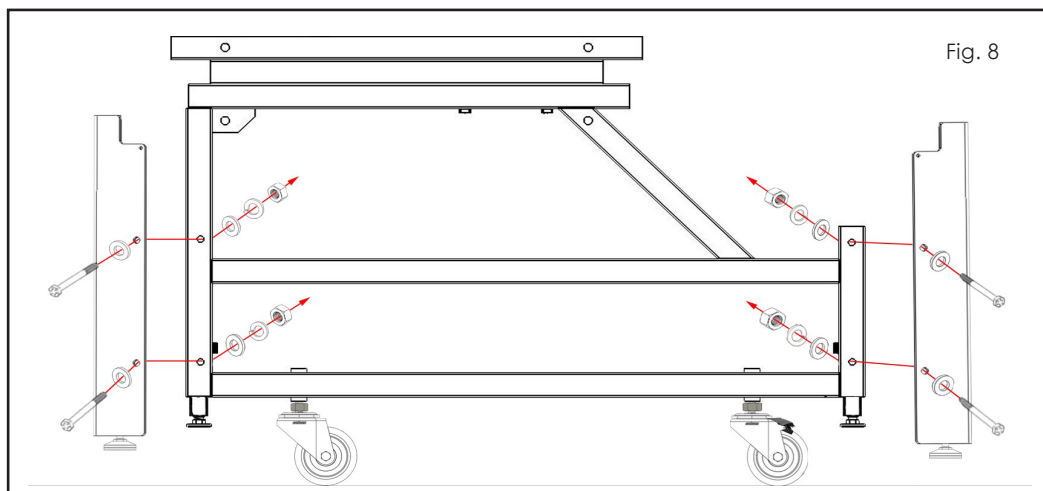
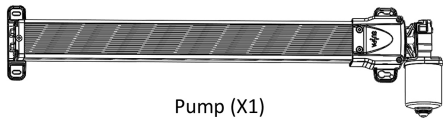

Fig. 8

# Gammill® INSTRUCTIONS

## Parts Index



Pump (X1)

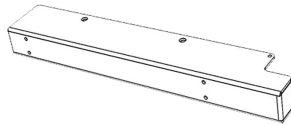

Cylinder Mount Bracket (X4)

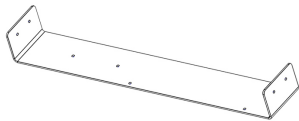

Pump Bracket "A" (X1)

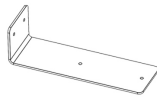

Pump Bracket "B" (X1)



Switch Bracket (X1)



AC Power Cord (X1)

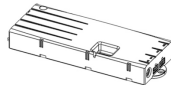

Controller (X1)

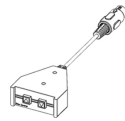

Low Profile Switch (X1)



Cylinder (X4)



11" Zip Tie (X10)

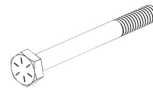

3/8" X 2-1/2" Bolt (X8)



10-32 X 3/8" BH Screw (X16)



8-32 X 3/4" Pan Head (X4)



10-32 X 3/4" Pan Head (X2)

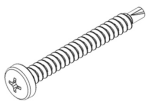

#8 X 1-1/2" Self-drilling Screw (X1)



#8 X 3/4" Self-drilling Screw (X9)



5/8" Hex Nut (X4)



3/8" Hex Nut (X8)



10-32 Keps Nut (X2)



8-32 Keps Nut (X4)



3/8" Flat Washer (X16)



3/8" Lock Washer (X8)



#8 Flat Washer (X4)



#10 Flat Washer (X2)

## Tools Required

Electric Drill/Screw gun

Phillips Screwdriver

9/16" Socket Wrench

9/16" Box Wrench

1/8" T-Handle Allen Wrench